



VDE SPECIAL PURPOSE USE UP TO 1000 V

OVERVIEW

- ✔ VDE Screwdrivers
- ✔ VDE Ratchets
- ✔ VDE Pliers
- ✔ VDE Sets





GEDORE VDE TOOLS



- ▶ All GEDORE VDE soft-plastic insulated safety tools have the Check-Tool insulation.
- ▶ The two-colour multi-layer insulation - red on the outside, yellow on the inside - complies with the BGV A3 (VGB-4) regulation. (The tool must not show any discernable damage).
- ▶ For technical reasons, Check-Tool insulation cannot be applied on tools with sprayed insulation.
- ▶ Tools marked with the double triangle are individually tested = testing at 10000 V AC to EN 60900 / IEC 60900:2004

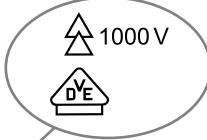

▶ Only tools with this test mark are considered to be fully safe.



▶ Some items in our VDE accessories range are marked with the usual test mark for protective equipment.



Safety Notes

- ▶ Work on electrically live equipment must be carried out only by trained electricians!
- ▶ Only tools and safety equipment marked with the double triangle or bell 1000 V symbol (refer to BGV A3) must be used.
- ▶ Before commencing any work, check the insulation for damage.
- ▶ Damaged tools must not be used!
- ▶ The regulations of the employers' liability insurance associations and power supply companies must be complied with!
- ▶ GEDORE VDE tools are approved for work on live circuits at voltages up to 1000 V AC and 1500 V DC.
- ▶ Tools must not be combined unless they are designed to be securely joined together.

For more VDE assortments see page 37





VDE INSULATED SAFETY TOOLS



- Only tools bearing this test mark are classed as insulated tools
- VDE insulation to IEC 60900:2004
- Safe working in high-voltage areas
- Up to 1000 V AC (alternating current)
- Up to 1500 V DC (direct current)



Some items in our VDE accessories range are marked with the usual test mark for protective equipment.

VDE ASSORTMENTS

VDE 1001

VDE TOOL SET 14 pieces

- With practical foam insert in sturdy PVC case
- Dimensions: 360 x 250 x 70 mm

12,5

1/2"



Code	No.	mm	mm	mm	mm
6602560	VDE 1001 VDE 19 10 12 13 14 17 19 22 24 VDE 1993 U VDE 1990-5 -10 VDE 1989 T VDE 2170 5,5 42 2,5	3.0			1



VDE 1030

VDE TOOL CABINET 108 pieces

- Complete with a selection of VDE tools
- Dimensions: 190 x 500 x 750 mm



Code	No.	mm	mm	mm	mm	
6602130	VDE 1030 VDE 2133 5 6 7 8 9 10 11 12 13 VDE 19 10 11 12 13 14 15 17 19 22 24 27 30 32 VDE IN 19 5 6 8 VDE 1990-5 -10 VDE 1993 U VDE 2170 2,5 4 5,5 6,5 VDE 2160 PH 0 1 2 VDE 894 10 11 12 13 14 15 16 17 19 VDE 8098-160 H VDE 8132-160 H VDE 8250-160 H VDE 8314-160 H VDE 4507-4 647 1021 4 K-500 6x 1500 H 1 17x 1500 H 2 27x 1500 H 3	46.0				1
5600730	VDE 1030 L Cabinet, empty	28.0			1	

VDE SPANNERS

VDE 2133

VDE SOCKET WRENCH with 3C-handle

- Hanging hole
- Head depth 25 mm, blade length 125 mm
- GEDORE vanadium steel 31CrV3
- With VDE insulation as per DIN EN 60900



Code	No.	mm	mm	mm	mm
1747045	VDE 2133 3	3	225	9	70
1747053	VDE 2133 4	4	225	10	70
1747061	VDE 2133 5	5	225	11	75
1747088	VDE 2133 6	6	225	12	75
1747096	VDE 2133 7	7	235	14	105
1747118	VDE 2133 8	8	235	15	110
1747126	VDE 2133 9	9	235	16	130
1747134	VDE 2133 10	10	235	17	130
1747142	VDE 2133 11	11	245	19	170
1747150	VDE 2133 12	12	245	20	170
1747169	VDE 2133 13	13	245	21	180
1747177	VDE 2133 14	14	245	22	230
1747185	VDE 2133 17	17	245	26	240

Detailed information on products, promotions and trade fairs

... www.gedore.com



VDE 2 E

VDE SINGLE ENDED RING

- SPANNER deep offset
- GEDORE vanadium steel 31CrV3



Code	No.	mm	mm	mm	mm
6035890	VDE 2 E 8	8	170	80	1
6035970	VDE 2 E 9	9	170	80	1
6036000	VDE 2 E 10	10	170	90	1
6036190	VDE 2 E 11	11	180	100	1
6036270	VDE 2 E 12	12	190	110	1
6036350	VDE 2 E 13	13	190	150	1
6036430	VDE 2 E 14	14	210	150	1
6036510	VDE 2 E 15	15	215	150	1
6036780	VDE 2 E 17	17	220	250	1
6036860	VDE 2 E 19	19	240	300	1
6036940	VDE 2 E 22	22	260	300	1
6037080	VDE 2 E 24	24	280	400	1
6037160	VDE 2 E 27	27	295	500	1
6037240	VDE 2 E 30	30	310	500	1
6037320	VDE 2 E 32	32	330	500	1



VDE 894

VDE SINGLE OPEN ENDED SPANNER

- GEDORE vanadium steel 31CrV3



Code	No.	mm	mm	mm	mm
6572040	VDE 894 9	9	105	25	1
6572120	VDE 894 10	10	105	30	1
6572200	VDE 894 11	11	115	35	1
6572390	VDE 894 12	12	125	45	1
6572470	VDE 894 13	13	135	50	1
6572550	VDE 894 14	14	145	60	1
6572630	VDE 894 15	15	150	70	1
6572710	VDE 894 16	16	155	80	1
6572980	VDE 894 17	17	160	85	1
6573010	VDE 894 19	19	175	110	1
6573280	VDE 894 22	22	200	150	1
6573360	VDE 894 24	24	220	210	1
6573440	VDE 894 27	27	245	265	1
6573520	VDE 894 30	30	265	320	1
6574920	VDE 894 32	32	280	400	1

VDE ACTUATING TOOLS

VDE 4507

VDE TORQUE WRENCH 1/2"

5-50 N-m / 4-37 lbf-ft

- Automatic short-way release and acoustic signal
- Manually adjustable dual scale with metric and SAE values
- Fine toothed ratchet with 1/2" square drive to DIN 3120 - A 12.5, ISO 1174

12.5
1/2"



1000 V

Code	No.	□"	↳mm↳	↕↔	⊞
6681920	VDE 4507-4	1/2	370	1000	1

VDE IN 19

VDE SCREWDRIVER BIT SOCKET 1/2"

- Square drive to DIN 3120 - C 12.5, ISO 1174, with ball groove
- Tips made of GEDORE special vanadium steel

12.5
1/2"



1000 V

Code	No.	□mm	↳mm↳	∅	↕↔	⊞
6124480	VDE IN 19 5	5	106	27	80	1
6124560	VDE IN 19 6	6	106	27	80	1
6124640	VDE IN 19 8	8	106	27	80	1

VDE 1993 U

VDE REVERSIBLE RATCHET 1/2" with switching lever

- Robust, with smooth action
- Sockets held absolutely securely by push-button lock with ball in the square drive
- Direction changed by 2 push-buttons, marked R and L, on the shaft
- Square drive acc. to DIN 3120 - A 12.5, ISO 1174, chrome-vanadium steel 31CrV3

12.5
1/2"



1000 V

Code	No.	□"	↳mm↳	↕↔	⊞
6123910	VDE 1993 U	1/2	270	540	1



VDE 1990

VDE EXTENSION 1/2"

- With lock screw to secure the sockets

12.5
1/2"



1000 V

Code	No.	↳mm↳	↕↔	⊞
6124050	VDE 1990-5	125	200	1
6124130	VDE 1990-10	250	350	1

VDE 19

VDE SOCKET 1/2"

- Hand-operated, square drive to DIN 3120 - C 12.5, ISO 1174
- GEDORE vanadium steel 31CrV3

12.5
1/2"

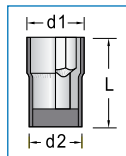

1000 V

Code	No.	□mm	d ₁	d ₂	L	↕↔	⊞
6122510	VDE 19 10	10	19.5	27	54.0	55	1
6122780	VDE 19 11	11	20.7	27	54.0	55	1
6122860	VDE 19 12	12	22.0	27	54.0	60	1
6122940	VDE 19 13	13	23.2	27	54.0	60	1
6123080	VDE 19 14	14	24.5	27	54.0	60	1
6123160	VDE 19 15	15	25.7	27	55.5	65	1
1439294	VDE 19 16	16	27.0	27	55.5	65	1
6123240	VDE 19 17	17	28.2	27	55.5	70	1
6123320	VDE 19 19	19	30.7	27	56.0	75	1
6123400	VDE 19 22	22	34.5	27	57.5	100	1
6123590	VDE 19 24	24	37.0	27	57.5	110	1
6123670	VDE 19 27	27	40.7	27	57.5	160	1
6123750	VDE 19 30	30	44.5	27	59.0	190	1
6123830	VDE 19 32	32	47.0	27	60.5	210	1

VDE 1988 - VDE 1989 T

VDE T-HANDLE for 1/2" VDE tools

- VDE 1988 with screw locking
- VDE 1989 T with pull locking

12.5
1/2"



1000 V

Code	No.	↳mm↳	↕↔	⊞
6124210	VDE 1988	200	400	1
6124720	VDE 1989 T	200	255	1

VDE SCREWDRIVER

VDE 2170

VDE SCREWDRIVER for slotted head screws

- Blade tip DIN ISO 2380-1 form A
- With impact-resistant handle

1000 V



1000 V

Code	No.	mm	↕↔	↕↔	↕↔	⊞
1612220	VDE 2170 2,5	0.4	75	155	24	10
1612239	VDE 2170 3	0.5	100	180	28	10
1612247	VDE 2170 3,5	0.6	100	190	39	10
1612255	VDE 2170 4	0.8	100	190	42	10
1612271	VDE 2170 5,5	1.0	125	225	71	10
1612298	VDE 2170 6,5	1.2	150	260	104	10
1612301	VDE 2170 8	1.2	175	195	144	10
1612336	VDE 2170 10	1.6	200	320	176	10

VDE 2160 PH

VDE SCREWDRIVER for cross-slotted head screws PH

- Blade tip to DIN ISO 8764-1 PH
- With impact-resistant handle

1000 V



1000 V

Code	No.	mm	↕↔	↕↔	↕↔	⊞
1612107	VDE 2160 PH 0	M1,6 - M2	60	140	25	10
1612115	VDE 2160 PH 1	M2 - M3	80	180	60	10
1612123	VDE 2160 PH 2	M3,5 - M5	100	210	92	10
1612131	VDE 2160 PH 3	M5,5 - M7	150	270	156	10
1612158	VDE 2160 PH 4	M8 - M10	200	320	235	10

VDE 1991

VDE EXTENSION 1/2" for VDE IN 19

- Hollow shaft, specially designed for VDE IN 19 screwdriver bit sockets
- Max. torque 370 N-m

12.5
1/2"



1000 V

Code	No.	↳mm↳	↕↔	⊞
1507516	VDE 1991	125	207	5



VDE 2160 PZ

VDE SCREWDRIVER

for cross-slotted head screws PZ

- Blade tip to DIN ISO 8764-1 PZ
- With impact-resistant handle



Code	No.	mm	mm	mm	mm
1612166	VDE 2160 PZ 0	M1,6 - M2	60	140	25 10
1612182	VDE 2160 PZ 1	M2 - M3	80	180	60 10
1612190	VDE 2160 PZ 2	M3,5 - M5	100	210	92 10
1612204	VDE 2160 PZ 3	M5,5 - M7	150	270	156 10
1612212	VDE 2160 PZ 4	M8 - M10	200	320	235 10

VDE 2170-2160 PH-077

VDE SCREWDRIVER SET 7 pieces



Code	No.	mm	mm	mm
1616048	VDE 2170-2160 PH-077	500	1	
	⊖ VDE 2170 2,5 4 5,5 6,5			
	⊕ VDE 2160 PH 0 1 2			

VDE 4614

VOLTAGE TESTER

bipolar with LED display

- 12 - 690 V AC/DC
- Optical warning of life-threatening voltage above 35 V
- Acoustic continuity testing up to 500 KOhm
- Single-pole phase testing > 100 V AC
- Phase sequence indicator
- RCD triggering by automatic load function, Is~30mA, ED (DT) = max. 30 sec.
- CAT IV 1000 V
- TUV / GS tested and approved (IEC/EN 61243-3, DIN VDE 0682, Part 401)



Code	No.	mm	mm
6698220	VDE 4614	186	1



VDE PLIERS

SB version = SB packaging

180

CABLE SHEARS

- Cuts cable up to 35 mm, solid material up to 180 mm²
- Not certified acc. to VDE



Code	No.	mm	mm	mm
6430330	180 23	620	1500	1

V 8091

CABLE CUTTER

- For cutting copper and aluminium cables
- V 8091-320: single-strand cable, max. Ø 25 mm (1"), multi-strand cable, max. Ø 32 mm (1.1/4")
- V 8091-500: multi-strand cable, max. Ø 52 mm (2.1/32")



Code	No.	mm	mm	mm
6725130	V 8091-320	280	599	1
6725210	V 8091-500	280	830	1

VDE 8094

VDE CABLE SHEARS with VDE dipped insulation

- For cutting multi-strand copper and aluminium cables up to Ø 20 mm
- Cutting to Ø 25 mm with first and second cut
- Adjustable screw joint and finger protection
- Not suitable for steel wire or hard-drawn copper wire
- Special tool steel, forged, gunmetal finish



Code	No.	mm	mm	mm
6725050	VDE 8094	200	280	1



VDE 8098

VDE STRIPPING PLIERS with VDE dipped insulation

- Opening stop, spring and brass adjusting screw for wires 0.8 - 6.0 mm²
- GEDORE special hardened and tempered steel, chrome-plated



Code	No.	mm	mm	mm
6708980	VDE 8098-160	160	150	1

VDE 8098 H

VDE STRIPPING PLIERS with VDE insulating sleeves

- Opening stop, spring and brass adjusting screw for wires 0.8 - 6.0 mm²
- GEDORE special hardened and tempered steel, chrome-plated



Code	No.	mm	mm	mm
1552074	VDE 8098-160 H	160	150	1

Code	No.	mm	mm	mm
1699997	SB VDE 8098-160 H	160	160	1



VDE 8099

VDE STRIPPING PLIERS STRIP-FIX with VDE dipped insulation

- Self-adjusting, for wires 0.5 - 5.0 mm²
- GEDORE special hardened and tempered steel, chrome-plated
- E-8099 = Pair of spare knives



Code	No.	mm	mm	mm
6709600	VDE 8099-160	160	170	1
5709580	E-8099	8	1	

VDE 8099 H

VDE STRIPPING PLIERS STRIP-FIX with VDE insulating sleeves

- Self-adjusting, for wires 0.5 - 5.0 mm²
- GEDORE special hardened and tempered steel, chrome-plated



Code	No.	mm	mm	
1552082	VDE 8099-160 H	160	170	1
1700804	SB VDE 8099-160 H	160	180	1

VDE 146

VDE UNIVERSAL PLIERS 7 settings

- Gripping pliers with safety box joint and finger protection
- GEDORE special chrome-vanadium steel



Code	No.	mm	mm	mm ²	
6120140	VDE 146 10	250	31	450	1
1699822	SB VDE 146 10	250	31	460	1



VDE 8250

VDE HEAVY DUTY COMBINATION PLIERS with VDE dipped insulation

- Induction-hardened precision cutting edges, hardness 62-64 HRC, for all wire types
- Industrial grade, constant use
- GEDORE special hardened and tempered steel, chrome-plated



Code	No.	mm	mm	
1429582	VDE 8250-160	160	240	1
6720090	VDE 8250-180	180	280	1
6720250	VDE 8250-200	200	360	1
6720330	VDE 8250-225	225	425	1

VDE 8250 H

VDE HEAVY DUTY COMBINATION PLIERS with VDE insulating sleeves

- Induction-hardened precision cutting edges, hardness 62-64 HRC, for all wire types
- Industrial grade, constant use
- GEDORE special hardened and tempered steel, chrome-plated



Code	No.	mm	mm	
1550942	VDE 8250-160 H	160	240	1
1550950	VDE 8250-180 H	180	280	1
1550969	VDE 8250-200 H	200	360	1

Code	No.	mm	mm	
1699830	SB VDE 8250-160 H	160	250	1
1699849	SB VDE 8250-180 H	180	290	1
1699857	SB VDE 8250-200 H	200	370	1

VDE 8314

VDE SIDE CUTTER with VDE dipped insulation

- For medium-hard and hard wire
- Induction-hardened precision cutting edges, hardness 63-65 HRC
- GEDORE special hardened and tempered steel, chrome-plated



Code	No.	mm	mm	
6743540	VDE 8314-140	140	160	1
6743620	VDE 8314-160	160	190	1

VDE 8314 H

VDE SIDE CUTTER with VDE insulating sleeves

- For hard wire
- Induction-hardened precision cutting edges, hardness 63-65 HRC
- GEDORE special hardened and tempered steel, chrome-plated



Code	No.	mm	mm	
1552155	VDE 8314-140 H	140	160	1
1552163	VDE 8314-160 H	160	190	1

Code	No.	mm	mm	
1699865	SB VDE 8314-140 H	140	170	1
1699873	SB VDE 8314-160 H	160	200	1

VDE 8315 H

VDE ELECTRICIANS' SIDE CUTTER with VDE insulating sleeves

- Double-function electricians' side cutters for cutting and wire stripping
- Stripping holes for single or multi-strand conductors 1.5 and 2.5 mm²
- Induction-hardened precision cutting edges
- GEDORE special hardened and tempered steel, chrome-plated



Code	No.	mm	mm ²	mm	
1742582	VDE 8315-160 H	160	1,6	200	1

Code	No.	mm	mm ²	mm	
1742698	SB VDE 8315-160 H	160	1,6	210	1

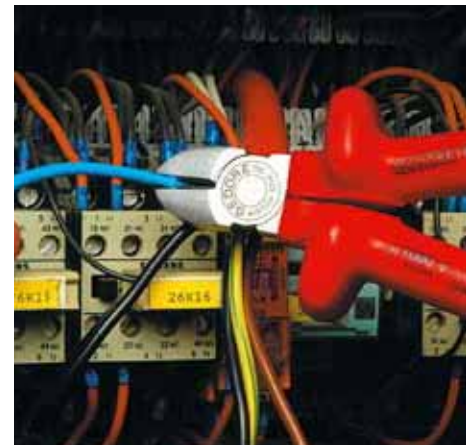

VDE 8316

VDE POWER SIDE CUTTER with VDE dipped insulation

- For hard wire, including piano wire
- Induction-hardened precision cutting edges, hardness 63-65 HRC
- GEDORE special hardened and tempered steel, chrome-plated



Code	No.	mm	mm	
1429590	VDE 8316-180	180	230	1
6742570	VDE 8316-200	200	350	1





VDE 8316 H

VDE POWER SIDE CUTTER with VDE insulating sleeves

- For hard wire
- Induction-hardened precision cutting edges, hardness 63-65 HRC
- GEDORE special hardened and tempered steel, chrome-plated



Code	No.	l-mm	l-mm	l
1550993	VDE 8316-180 H	180	230	1
1551000	VDE 8316-200 H	200	350	1

Code	No.	l-mm	l-mm	l
1699881	SB VDE 8316-180 H	180	240	1
1699903	SB VDE 8316-200 H	200	360	1

VDE 8120

VDE FLAT NOSE PLIERS with VDE dipped insulation

- Long, flat jaws and serrated gripping surfaces
- GEDORE special hardened and tempered steel, chrome-plated



Code	No.	l-mm	l-mm	l
6715330	VDE 8120-160	160	200	1

VDE 8120 H

VDE FLAT NOSE PLIERS with VDE insulating sleeves

- Long, flat jaws and serrated gripping surfaces
- GEDORE special hardened and tempered steel, chrome-plated



Code	No.	l-mm	l-mm	l
1552090	VDE 8120-160 H	160	200	1

Code	No.	l-mm	l-mm	l
1699970	SB VDE 8120-160 H	160	210	1



VDE 8122

VDE ROUND NOSE PLIERS with VDE dipped insulation

- Long, round jaws and serrated gripping surfaces
- GEDORE special hardened and tempered steel, chrome-plated



Code	No.	l-mm	l-mm	l
6717110	VDE 8122-160	160	180	1

VDE 8122 H

VDE ROUND NOSE PLIERS with VDE insulating sleeves

- Long, round jaws and serrated gripping surfaces
- GEDORE special hardened and tempered steel, chrome-plated



Code	No.	l-mm	l-mm	l
1552104	VDE 8122-160 H	160	180	1

Code	No.	l-mm	l-mm	l
1699989	SB VDE 8122-160 H	160	190	1

Detailed information on products, promotions and trade fairs

... www.gedore.com



VDE 8132

VDE NEEDLE NOSE PLIERS with VDE dipped insulation, straight pattern

- Long, flat-round jaws, straight gripping surfaces
- Induction-hardened precision cutting edges, hardness 61-63 HRC
- GEDORE special hardened and tempered steel, chrome-plated



Code	No.	l-mm	l-mm	l
6721570	VDE 8132-160	160	150	1
6721650	VDE 8132-200	200	210	1



VDE 8132 H

VDE NEEDLE NOSE PLIERS with VDE insulating sleeves, straight pattern

- Long, flat-round jaws, straight gripping surfaces
- Induction-hardened precision cutting edges, hardness 61-63 HRC
- GEDORE special hardened and tempered steel, chrome-plated



Code	No.	l-mm	l-mm	l
1552112	VDE 8132-160 H	160	150	1
1552120	VDE 8132-200 H	200	210	1

Code	No.	l-mm	l-mm	l
1699911	SB VDE 8132-160 H	160	160	1
1699938	SB VDE 8132-200 H	200	220	1

VDE 8132 AB

VDE NEEDLE NOSE PLIERS
with VDE dipped insulation, angled pattern

- Long, flat-round jaws, angled gripping surfaces
- Induction-hardened precision cutting edges, hardness 61-63 HRC
- GEDORE special hardened and tempered steel, chrome-plated



Code	No.	l-mm	l-mm	U
6721730	VDE 8132 AB-160	160	150	1
6721810	VDE 8132 AB-200	200	210	1



VDE 8132 AB H

VDE NEEDLE NOSE PLIERS
with VDE insulating sleeves, angled pattern

- Long, flat-round jaws, angled gripping surfaces
- Induction-hardened precision cutting edges, hardness 61-63 HRC
- GEDORE special hardened and tempered steel, chrome-plated



Code	No.	l-mm	l-mm	U
1552139	VDE 8132 AB-160 H	160	150	1
1552147	VDE 8132 AB-200 H	200	210	1

Code	No.	l-mm	l-mm	U
1699946	SB VDE 8132 AB-160 H	160	160	1
1699962	SB VDE 8132 AB-200 H	200	220	1

VDE 8133 H

VDE TRIPLE PLIERS

- Flat-round tapered jaws
- With wire cutter and stripper
- For stripping and crimping of 0.5/1.5 and 2.5 mm²
- Crimper for conductor end-sleeves, with normal long nose



Code	No.	l-mm	l-mm	U
1997386	VDE 8133-180 H	180	190	5

Code	No.	l-mm	l-mm	U
2011468	SB VDE 8133-180 H	180	200	5

VDE S 8003

VDE PLIERS SET WITH VDE DIPPED INSULATION 3 pieces



Code	No.	U	U
6708120	VDE S 8003 VDE 8132-160 VDE 8250-180 VDE 8314-160	740	1

VDE S 8003 H

VDE PLIERS SET WITH VDE INSULATING SLEEVES 3 pieces

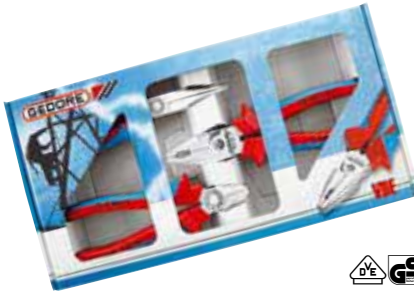

Code	No.	U	U
1550594	VDE S 8003 H VDE 8132-160 H VDE 8250-180 H VDE 8314-160 H	740	1

RZB1-17

VDE TOOL SET 8 pieces



Code	No.	U	U
1828045	RZB1-17 VDE 8132-200 H VDE 8250-180 H VDE 8314-160 H VDE 2170 4 5,5 VDE 2160 PH 1 2 4615 3	1700	1

RZB2-5

VDE PLIERS SET 3 pieces



Code	No.	U	U
1708244	RZB2-5 VDE 8098-160 H VDE 8250-180 H VDE 8314-160 H	835	1

RZB2-11

VDE PLIERS SET 3 pieces



Code	No.	U	U
1692291	RZB2-11 VDE 8132-160 H VDE 8250-180 H VDE 8314-160 H	865	1





VDE ACCESSORIES

VDE 910

VDE RUBBER COVER SHEET

► VDE protective equipment to VDE 0680, Part 1



Code	No.	L	W	↕	📦
1826816	VDE 910 13	130	130	40	1
1826832	VDE 910 25	250	350	210	1
1827030	VDE 910 50	500	500	430	1
1828193	VDE 910 60	600	600	700	1
1828207	VDE 910 100	1000	1000	1800	1
1828215	VDE 910 120	1200	1200	2950	1

VDE 910

VDE RUBBER COVER SHEET 10 M ROLL



Code	No.	W	↕	📦
1828223	VDE 910 1000	1000	18.6	1
1828231	VDE 910 1200	1200	25.6	1

VDE 911

VDE INSULATION MAT

► VDE protective equipment to VDE 0303



Code	No.	L	W	↕	📦
1828258	VDE 911 100	1000	1000	6.0	1
1828266	VDE 911 1000	10000	1000	60.0	1



VDE 912

VDE ELECTRICIANS' SAFETY GLOVES

► To DIN EN 60903



⚡ 1000 V

Code	No.	↕	📦
1828274	VDE 912 9	215	1
1828282	VDE 912 10	215	1

VDE 912

UNDER-GLOVES for VDE 912



Code	No.	↕	📦
1828290	VDE 912 50	50	1

VDE 913

VDE PLASTIC CLAMP

► VDE protective equipment to VDE 0680, Part 1



Code	No.	↔ (mm)	↕	📦
1828304	VDE 913 80	80	30	1
1828312	VDE 913 160	160	70	1

VDE VARIOUS

VDE 4522

VDE CABLE KNIFE

► Strong, straight blade made from hardened and tempered steel
► Tough, resilient plastic handle



⚡ 1000 V

Code	No.	↔	↔	↕	📦
6690400	VDE 4522	50	180	70	5

Detailed information on products, promotions and trade fairs

... www.gedore.com



VDE 4527

VDE CABLE KNIFE with hooked blade

► For slitting and stripping damp-proof installation cables
► With blade protector



⚡ 1000 V

Code	No.	↔	↔	↕	📦
6698490	VDE 4527	40	203	100	1

V 406

VDE HACKSAW

► For pinned hacksaw blades, 148 mm
► Insulated handle



⚡ 1000 V

Code	No.	↔ (mm)	↕	📦
6120060	V 406	265	180	1

